



Self-Contained Emergency Luminaire

(Escape route lighting device)

PTH-100 (1.0W Power LED)

PTH - 100



ID Registration Application No: 15-01266-0101

Specifications

- Model ➔ PTH-100.
- Light Source ➔ 1.0W high power LED.
- Mode ➔ Non-maintained.
- Weight ➔ 260 grams.
- Battery ➔ 2.4V 1.0AH Ni-Cad or 2.4V 1.6AH Ni-MH.
- Housing ➔ Injection moulded fire retardant, UV stabilize ABS Housing.
- Charger ➔ Constant Current.
- Mounting ➔ Surface mounted.
- Dimension ➔ 100mm (Dia) x 73mm (Height).
- Monitoring ➔ Green / Red LED " ON " to indicate charging.
Equipped with push test switch to simulate power failure.
- Compliance ➔ SIRIM MS 619-2-22:2005, MS IEC 60598-1:2012.
Jabatan Bomba dan Penyelamat Malaysia Certified.
- Input Voltage ➔ 240V +/- 10% 50Hz.
- Input Power ➔ 2.2W.
- Recharge Period ➔ 16 - 24 hours.
- Back Up Duration ➔ 3 hours.
- Battery Protection ➔ Low voltage cut-off to prevent over discharging.
- Ingress of Protection ➔ IP - 20.
- Operating Temperature ➔ 0 °C to 65 °C.
- Lumen ➔ 68 lm.

For further enquiries, please contact :-
PNE SYSTEMS SDN. BHD. (263861 D)
 No.3, Jalan SS26/13, Taman Mayang Jaya
 47301, Petaling Jaya, Selangor Darul Ehsan.
 Tel : (6)03-78037488 (Hunting)
 Fax : (6)03-78038509
 E-mail : sales@pnesys.com.my
 Website : www.pnesys.com.my

Note :

- * Industrial Design of PTH-100 is approved by Intellectual Property Corporation Of Malaysia. Design No : MY15-01266-0101.
- * Due to continuous development and improvement, our company reserves the right to change specifications without notice.



PTH 100 EMERGENCY LIGHTING DIMENSION

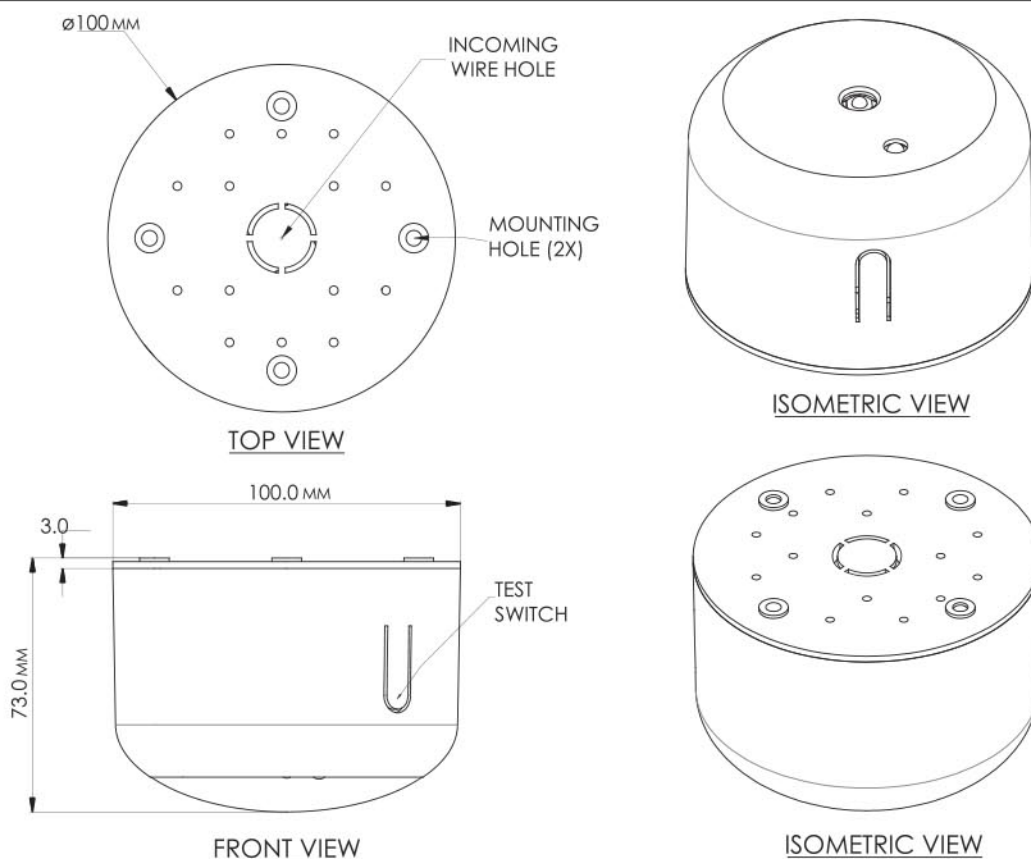

INSTALLATION

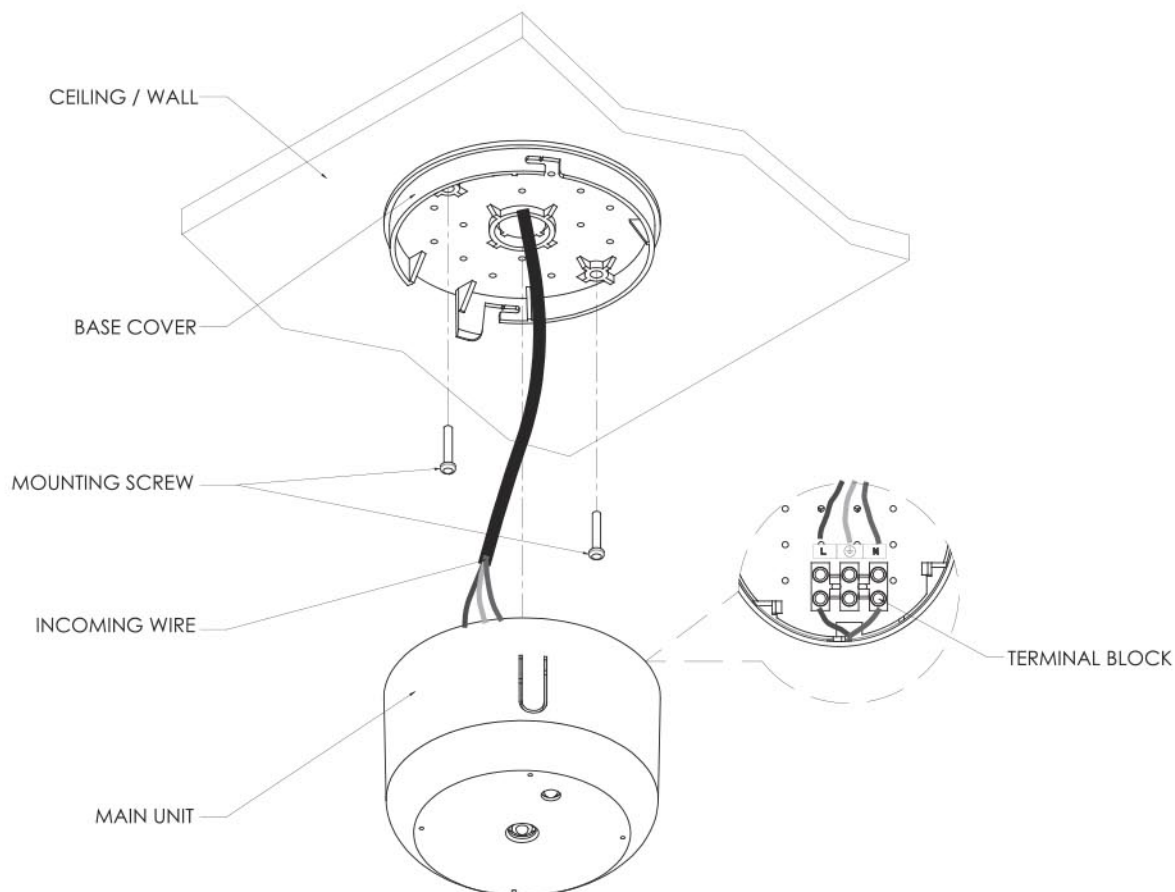

INSTALLATION OF PTH 100